



127 SERIES JAP



Specially designed for the Japanese market
Poppet Valve closing system

• Materials

Carbon Steel *EN -10277-3*,

Seals: NBR, Viton or EPDM

Back-up-ring: PTFE

Balls: *AISI 1010/1015*

Springs: *Carbon Steel DIN 17233/84(B)*

• **Applications:** Designed for Oil hydraulic Applications according to European Directive 97.23.EC

• Equivalence

FASTER HNVY

• Working temperature (Seals)

	NBR	Viton	EPDM
	+100°C	+200°C	+150°C
	-30°C	-10°C	-40°C

• **Sectors:** Agricultural, Industrial



MODEL STRUCTURE

Example;

127.11115 AF

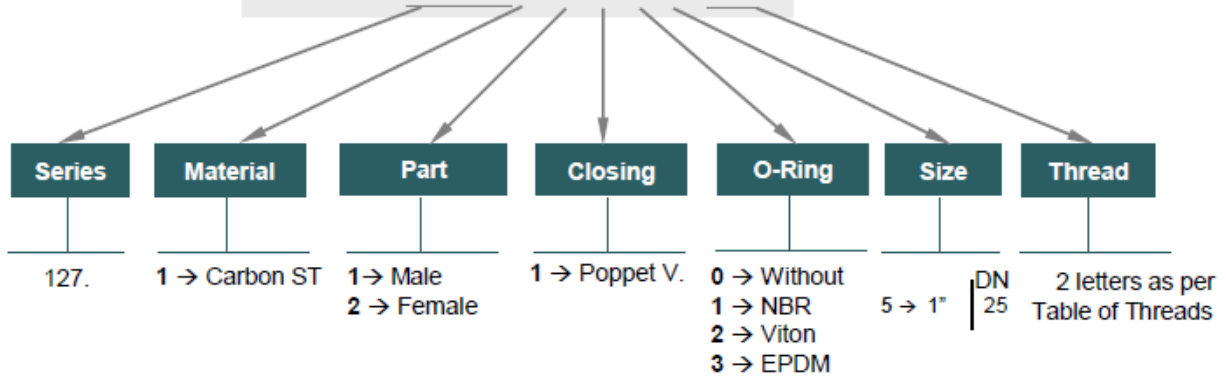

127-1



127 SERIES JAP

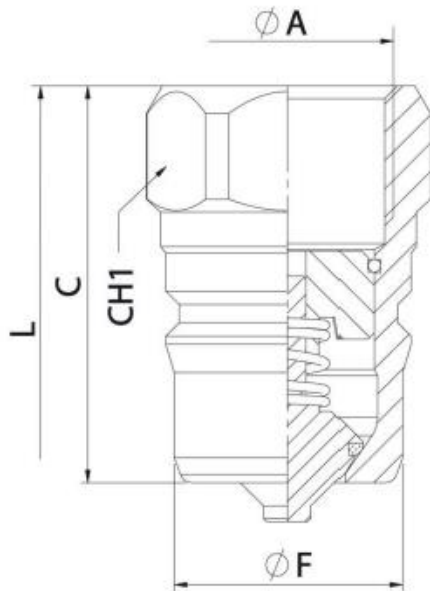

MALE							
DN	ϕA	CH1	C	ϕF	L	REF.	
25	1" BSP	41	63	36,20	126	127.11115AF	250Bar

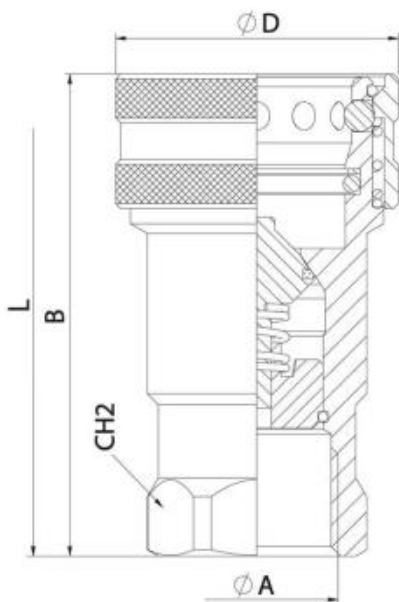

FEMALE							
DN	ϕA	CH2	B	ϕD	L	REF.	
25	1" BSP	41	98	58	126	127.12115AF	250 Bar

127-2

