



# 131 SERIES CPR



Manufactured according ISO 16028 norm.  
Flat Poppet Valve which avoids fluid leakages during the connection and disconnection.

### • Materials

Carbon Steel *EN -10277-3 / AISI 316L*

Seals: NBR. Viton or EPDM

Back-up-ring: PTFE

Balls: *AISI 1010/1015*

Springs: *Carbon Steel DIN 17233/84(B)*

• **Applications:** Designed for Oil hydraulic Applications according to European Directive 97.23.EC

### • Equivalence

FASTER 2FFI  
PARKER FEM  
AEROQUIP FD89  
SNAP-TITE 74

### • Working temperature (Seals)

	NBR	Viton	EPDM
+	+100°C	+200°C	+150°C
-	-30°C	-10°C	-40°C

• **Sectors:** Industrial, Building Machinery



### MODEL STRUCTURE

Example;

## 131.11113 AD

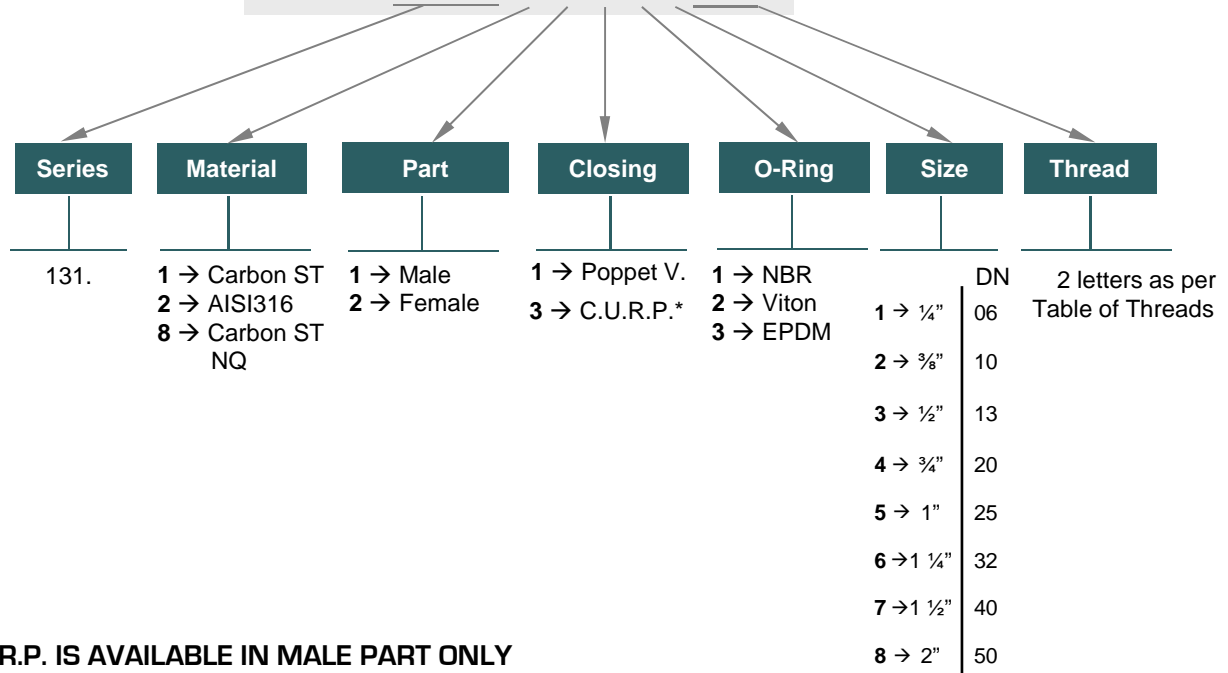

\* C.U.R.P. IS AVAILABLE IN MALE PART ONLY

## 131-1





# 131 SERIES CPR

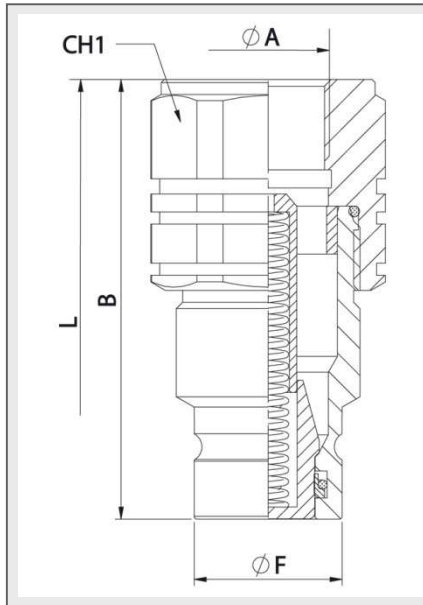

MALE				
DN	CH1	B	ØF	L
07	22	48	16,20	85,50
09	30	62,50	19,80	116,50
13	36	62,50	24,50	134,50
15	36	70,50	27	132
17	41	82,50	30	154
21	55	90	36	173
30	65	111	57	215
45	75	125	73	

STANDARD MODELS				
DN	ØA	MALE	FEMALE	
07	1/4" BSP	131.11111AB	131.12111AB	500Bar
	1/4" NPTF	131.11111BB	131.12111BB	
09	3/8" BSP	131.11112AC	131.12112AC	350Bar
	3/8" NPTF	131.11112BC	131.12112BC	
	1/2" BSP	131.11112AD	131.12112DC	
	1/2" NPTF	131.11112BD	131.12112BD	
13	3/4" -16ORB	131.11112GF	131.12112GF	330Bar
	3/4" -14ORB	131.11112GH	131.12112GH	
	1/2" BSP	131.11113AD	131.12113AD	
	1/2" NPTF	131.11113BD	131.12113BD	
	3/4" BSP	131.11113AE	131.12113AE	
	3/4" NPTF	131.11113BE	131.12113BE	
15	1 1/16" -12ORB	131.11113GK	131.12113GK	300Bar
	3/4" BSP	131.11114AE	131.12114AE	
17	1" NPTF	131.11114BE	131.12114BE	280Bar
	1" BSP	131.11115AF	131.12115AF	
21	1 1/16" -12ORB	131.11115BF	131.12115BF	250Bar
	1 1/2" BSP	131.11115GO	131.12115GO	
30	1 1/4" BSP	131.11116AG	131.12116AG	250Bar
	1 1/2" NPTF	131.11116BG	131.12116BG	
45	1 1/2" BSP	131.11117AH	131.12117AH	250Bar
	1 1/2" NPTF	131.11117BH	131.12117BH	
45	2" BSP	131.11118AI	131.12118AI	250Bar

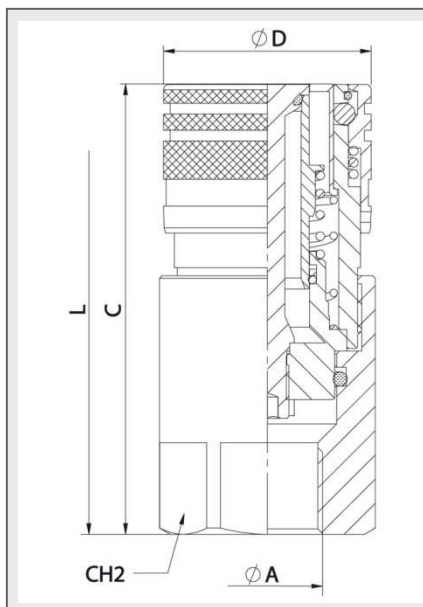

FEMALE				
DN	CH2	C	ØD	L
07	27	48	28	85,50
09	30	64,50	32	116,50
13	41	80,50	38	134,50
15	41	78	42	132
17	46	92,50	48	154
21	55	105	55	173
30	65	132,50	80	215
45	80	165	100	





# 131 SERIES CPR

DIN2353

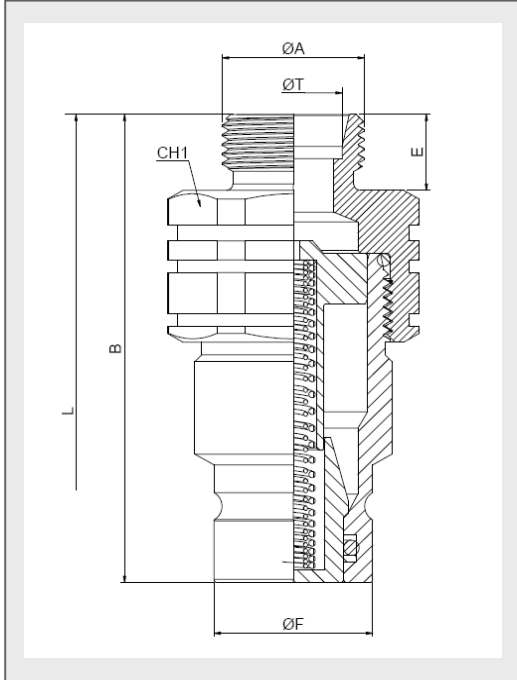

## STANDARD MALE MODELS

DN	ØA	ØT	REF.		CH1	B	ØF	E	L
07	M12x1,5	6L	131.11111JB	500 Bar	22	55	16,2	12	106,2
	M14x1,5	8L	131.11111JC			54		11	104,2
	3/8" BSP M.	*	131.11112AN			62,5		12	124,4
09	M14x1,5	8L	131.11112JC	350 Bar	30	61,5	19,79	11	122,2
	M16x1,5	10L	131.11112JD			62,5		12	124,4
	M16x1,5	8S	131.11112KD						
	M18x1,5	10S	131.11112KE			73		11	134,9
	M20x1,5	12S	131.11112KF						
	M14x1,5	8L	131.11113JC						
M16x1,5	10L	131.11113JD							
13	M18x1,5	12L	131.11113JE	330 Bar	36	74	24,58	12	136,9
	M22x1,5	15L	131.11113JG						
	M26x1,5	18L	131.11113JI						
	M18x1,5	10S	131.11113KE						
	M20x1,5	12S	131.11113KF						
	M22x1,5	14S	131.11113KG						
	M24x1,5	16S	131.11113KH						
	M18x1,5	12I	131.11114JE						
	M22x1,5	15L	131.11114JG						
	M26x1,5	18L	131.11114JI						
15	M30x2	22L	131.11114JJ	330 Bar	36	80	27,08	18	151,5
	M22x1,5	14S	131.11114KG						
	M24x1,5	16S	131.11114KH						
	M30x2	20S	131.11114KJ						
	M26x1,5	18L	131.11115JI						
	M30x2	22L	131.11115JJ						
17	M36x2	28L	131.11115JK	330 Bar	41	88	30	18	164,2
	M45x2	35L	131.11115JM						
	M30x2	20S	131.11115KJ						
	M36x2	25S	131.11115KK						
	M42x2	30S	131.11115KL						
	M52x2	38S	131.11115KN						
	M42x2	30S	131.11115KL						
	M52x2	38S	131.11115KN						

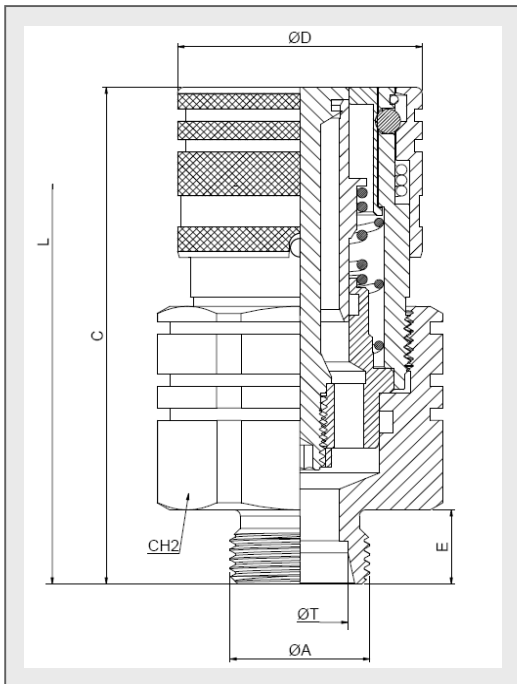

## STANDARD FEMALE MODELS

DN	ØA	ØT	REF.		CH2	C	ØD	E	L
07	M12x1,5	6L	131.12111JB	500 Bar	27	62	27,5	12	106,2
	M14x1,5	8L	131.12111JC			63		11	104,2
	3/8" BSP M.	*	131.12112AN			77,5		12	124,4
09	M14x1,5	8L	131.12112JC	350 Bar	30	76,5	33	11	122,2
	M16x1,5	10L	131.12112JD			77,5		12	124,4
	M16x1,5	8S	131.12112KD						
	M18x1,5	10S	131.12112KE			79,5		11	134,9
	M20x1,5	12S	131.12112KF						
	M14x1,5	8L	131.12113JC						
M16x1,5	10L	131.12113JD							
13	M18x1,5	12L	131.12113JE	330 Bar	41	80,5	38,5	12	136,9
	M22x1,5	15L	131.12113JG						
	M26x1,5	18L	131.12113JI						
	M18x1,5	10S	131.12113KE						
	M20x1,5	12S	131.12113KF						
	M22x1,5	14S	131.12113KG						
	M24x1,5	16S	131.12113KH						
	M18x1,5	12I	131.12114JE						
	M22x1,5	15L	131.12114JG						
	M26x1,5	18L	131.12114JI						
15	M30x2	22L	131.12114JJ	330 Bar	41	89,1	42	18	151,5
	M22x1,5	14S	131.12114KG						
	M24x1,5	16S	131.12114KH						
	M30x2	20S	131.12114KJ						
	M26x1,5	18L	131.12115JI						
	M30x2	22L	131.12115JJ						
17	M36x2	28L	131.12115JK	330 Bar	46	98	30	18	164,2
	M45x2	35L	131.12115JM						
	M30x2	20S	131.12115KJ						
	M36x2	25S	131.12115KK						
	M42x2	30S	131.12115KL						
	M52x2	38S	131.12115KN						
	M42x2	30S	131.12115KL						
	M52x2	38S	131.12115KN						



# 131 SERIES CPR

DIN2353

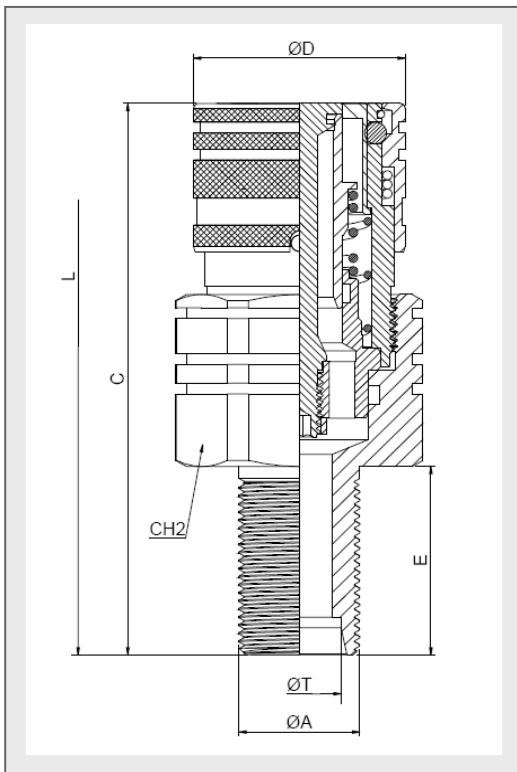
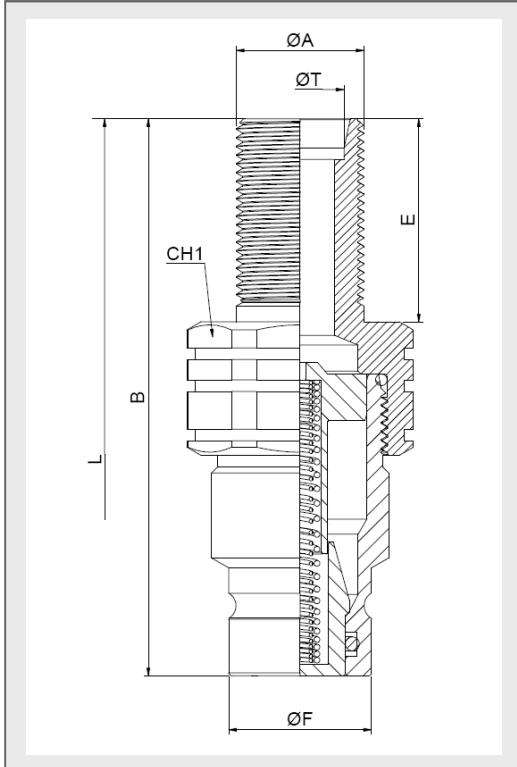

## STANDARD MALE MODELS

DN	ØA	ØT	REF.		CH1	B	ØF	E	L
07	M12x1,5	6L	131.11111LB	500Bar	22	68	16,2	25	132,2
	M14x1,5	8L	131.11111LC			77		34	150,2
	M14x1,5	8L	131.11112LC			84,5		34	168,2
09	M16x1,5	10L	131.11112LD	350Bar	30	85,5	19,79	35	170,2
	M16x1,5	8S	131.11112MD			76,5		26	152,2
	M18x1,5	10S	131.11112ME			77,5		27	154,2
	M20x1,5	12S	131.11112MF			85,5		35	170,2
	M14x1,5	8L	131.11113LC			97		34	182
13	M16x1,5	10L	131.11113LD	330Bar	41	96	24,58	35	183
	M18x1,5	12L	131.11113LE						183
	M22x1,5	15L	131.11113LG						183
	M26x1,5	18L	131.11113LI						183
	M18x1,5	10S	131.11113ME						183
	M20x1,5	12S	131.11113MF						182
	M22x1,5	14S	131.11113MG						182
15	M24x1,5	16S	131.11113MH	330Bar	41	96	27,08	35	185,5
	M18x1,5	12I	131.11114LE						185,5
	M22x1,5	15L	131.11114LG						185,5
	M26x1,5	18L	131.11114LI						185,5
	M30x2	22L	131.11114LJ						185,5
	M24x1,5	16S	131.11114MH						184,5
	M30x2	20S	131.11114MJ						184,5
17	M26x1,5	18L	131.11115LI	330Bar	46	106	30	35	199,2
	M30x2	22L	131.11115LJ						199,2
	M36x2	28L	131.11115LK						199,2
	M45x2	35L	131.11115LM						186,2
	M30x2	20S	131.11115MJ						186,2
	M36x2	25S	131.11115MK						198,2
	M42x2	30S	131.11115ML						205,2
	M52x2	38S	131.11115MN						199,2
									199,2
									196,2

## STANDARD FEMALE MODELS

DN	ØA	ØT	REF.		CH2	C	ØD	E	L
07	M12x1,5	6L	131.12111LB	500Bar	27	75	27,5	25	132,2
	M14x1,5	8L	131.12111LC			84		34	150,2
	M14x1,5	8L	131.12112LC			99,5		34	168,2
09	M16x1,5	10L	131.12112LD	350Bar	30	100,5	33	35	170,2
	M16x1,5	8S	131.12112MD			91,5		26	152,2
	M18x1,5	10S	131.12112ME			92,5		27	154,2
	M20x1,5	12S	131.12112MF			100,5		35	170,2
	M14x1,5	8L	131.12113LC			102,5		34	182
13	M16x1,5	10L	131.12113LD	330Bar	41	102,5	38,5	35	183
	M18x1,5	12L	131.12113LE						183
	M22x1,5	15L	131.12113LG						183
	M26x1,5	18L	131.12113LI						183
	M18x1,5	10S	131.12113ME						182
	M20x1,5	12S	131.12113MF						182
	M22x1,5	14S	131.12113MG						182
15	M24x1,5	16S	131.12113MH	330Bar	41	103,5	42	35	185,5
	M18x1,5	12I	131.12114LE						185,5
	M22x1,5	15L	131.12114LG						185,5
	M26x1,5	18L	131.12114LI						185,5
	M30x2	22L	131.12114LJ						185,5
	M24x1,5	16S	131.12114MH						184,5
	M30x2	20S	131.12114MJ						184,5
17	M26x1,5	18L	131.12115LI	330Bar	46	115	48,5	35	199,2
	M30x2	22L	131.12115LJ						199,2
	M36x2	28L	131.12115LK						199,2
	M45x2	35L	131.12115LM						186,2
	M30x2	20S	131.12115MJ						186,2
	M36x2	25S	131.12115MK						198,2
	M42x2	30S	131.12115ML						205,2
	M52x2	38S	131.12115MN						199,2
									199,2
									196,2





# 131 SERIES

## CPR

### C.U.R.P.



Manufactured according ISO 16028 norm.

Flat Poppet Valve which avoids fluid leakages during the connection and disconnection.

	NBR	Viton	EPDM
	+100°C	+200°C	+150°C
	-30°C	-10°C	-40°C

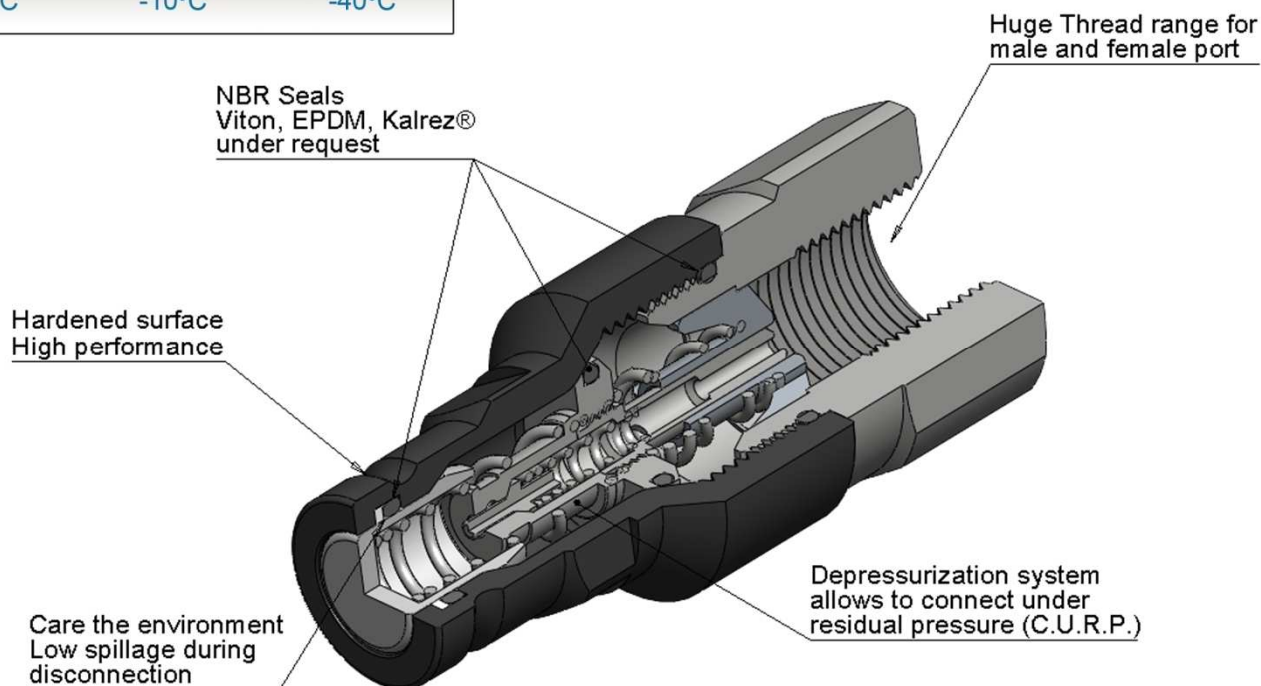

STANDARD MODEL CARBON STEEL						
DN	Port	REF.	Working Pressure	Rated Flow	Max. Residual Pressure	Spillage
09	3/8" BSP	131.11312AC	350 Bar	45 l/min	300 Bar	0,010 ml
13	1/2" BSP	131.11313AD	330 Bar	90 l/min	300 Bar	0,010 ml
15	3/4" BSP	131.11314AE	330 Bar	200 l/min	300 Bar	0,120 ml
17	1" BSP	131.11315AF	330 Bar	300 l/min	250 Bar	0,200 ml
21	1 1/4" BSP	131.11316AG	300 Bar	380 l/min	250 Bar	0,250 ml
30	1 1/2" BSP	131.11317AH	280 Bar	750 l/min	200 Bar	0,300 ml

131-5







# 131 SERIES

## CPR

STAINLESS STEEL  
AISI 316



Manufactured according ISO 16028 norm.  
Flat Poppet Valve which avoids fluid leakages during the connection and disconnection.

### • Materials

Stainless steel AISI 316  
Seals: NBR, Viton or EPDM  
Back-up-ring: PTFE  
Balls: AISI 1010/1015  
Springs: AISI302 DIN17224

### • Working temperature (Seals)

	NBR	Viton	EPDM
+	+100°C	+200°C	+150°C
-	-30°C	-10°C	-40°C

• **Applications:** Designed for Oil hydraulic Applications according to European Directive 97.23.EC Special for American market

• **Sectors:** Industrial, Chemical

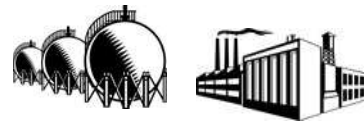

### MODEL STRUCTURE

Example;

**131.21123 AD**

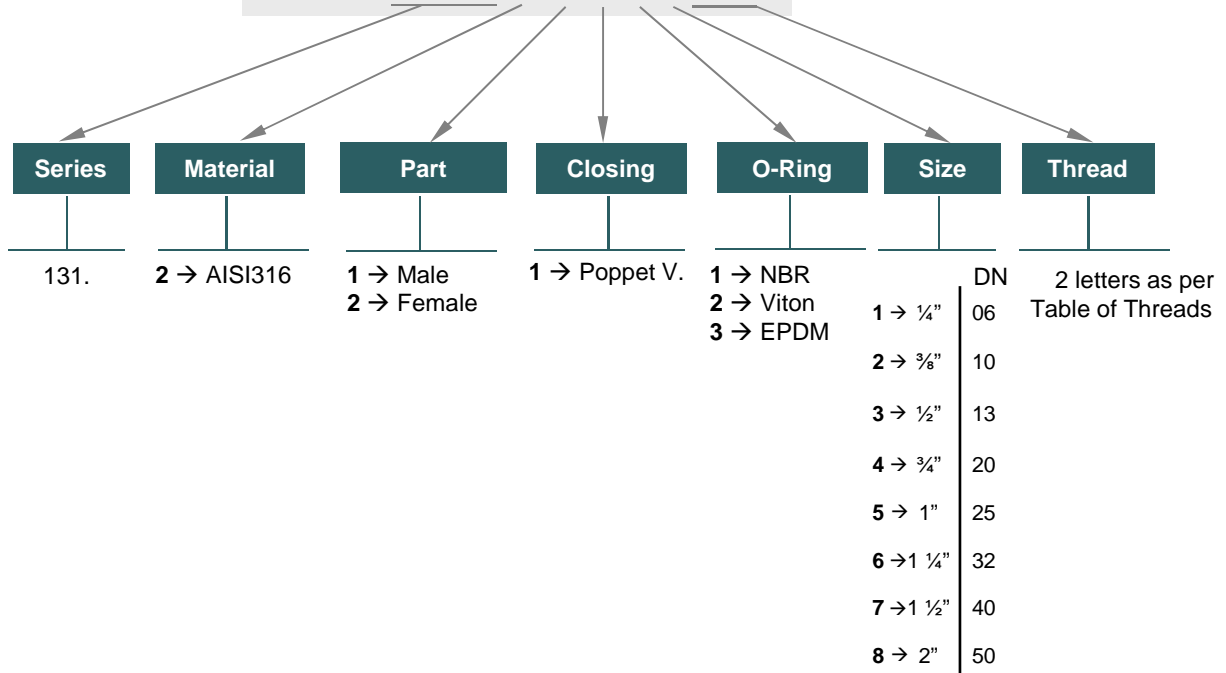

**131-6**





# 131 SERIES

## CPR

STAINLESS STEEL  
AISI 316

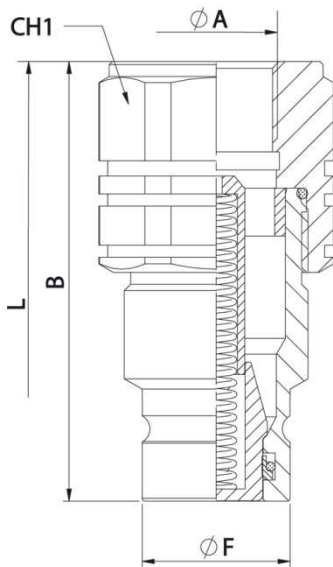

MALE				
DN	CH1	B	ØF	L
07	22	48	16,20	85,50
09	30	62,50	19,80	116,50
13	36	62,50	24,50	134,50
15	36	70,50	27	132
17	41	82,50	30	154
21	55	90	36	173
30	65	111	57	215
45	75	125	73	

### STANDARD MODELS

DN	ØA	MALE	FEMALE		
07	1/4" BSP	131.21121AB	131.22121AB	350Bar	
		131.21121BB	131.22121BB		
09	3/8" BSP	131.21122AC	131.22122AC	250Bar	
		131.21122BC	131.22122BC		
	1/2" BSP	131.21122AD	131.22122DC		
	1/2" NPTF	131.21122BD	131.22122BD		
13	3/4" -16ORB	131.21122GF	131.22122GF	250Bar	
		3/8" -14ORB	131.21122GH		131.22122GH
	1/2" BSP	131.21123AD	131.22123AD		
	1/2" NPTF	131.21123BD	131.22123BD		
15	3/4" BSP	131.21123AE	131.22123AE	250Bar	
		3/4" NPTF	131.21123BE		131.22123BE
17	1" -14ORB	131.21123GH	131.22123GH	250Bar	
		1 1/16" 12ORB	131.21123GK		131.22123GK
		3/4" BSP	131.21124AE		131.22124AE
21	1" NPTF	131.21124BE	131.22124BE	250Bar	
		1 1/16" -12ORB	131.21124GK		131.22124GK
30	1" BSP	131.21125AF	131.22125AF	250Bar	
		1" NPTF	131.21125BF		131.22125BF
45	1 5/16" -12ORB	131.21125GO	131.22125GO	100Bar	
		1 1/4" BSP	131.21126AG		131.22126AG
07	1 1/4" NPTF	131.21126BG	131.22126BG	250Bar	
		1 1/2" BSP	131.21127AH		131.22127AH
09	1 1/2" NPTF	131.21127BH	131.22127BH	250Bar	
		2" BSP	131.21128AI		131.22128AI

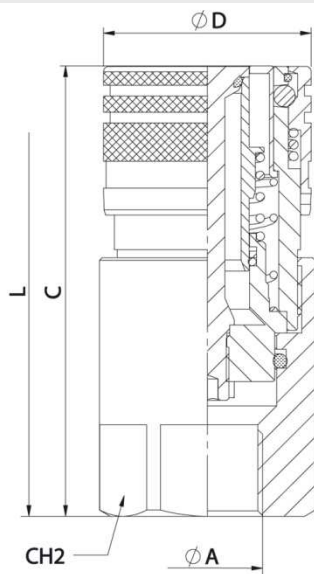

FEMALE				
DN	CH2	C	ØD	L
07	27	48	28	85,50
09	30	64,50	32	116,50
13	41	80,50	38	134,50
15	41	78	42	132
17	46	92,50	48	154
21	55	105	55	173
30	65	132,50	80	215
45	80	165	100	



# 131 SERIES CPR



TECHNICAL DATA		Carbon Steel			
DN	Rated Flow	Min Burst Pressure (bar)			Max. Working Pressure
		Male	Female	Coupled	
07	18 l/m	1950	1850	2000	500 Bar
09	45 l/m	1300	1200	1400	350 Bar
13	75 l/m	1300	1200	1400	330 Bar
15	150 l/m	1250	1180	1400	330 Bar
17	200 l/m	1200	1150	1400	330 Bar
21	220 l/m	1150	1150	1400	300 Bar
30	240 l/m	1080	1100	1400	280 Bar

TECHNICAL DATA		Stainless Steel			
DN	Rated Flow	Min Burst Pressure (bar)			Max. Working Pressure
		Male	Female	Coupled	
07	18 l/m	1450	1400	1400	350 Bar
09	45 l/m	1020	1100	1000	250 Bar
13	75 l/m	1000	980	1000	250 Bar
15	150 l/m	950	970	1000	250 Bar
17	200 l/m	950	940	1000	250 Bar
21	220 l/m	930	900	1000	250 Bar
30	240 l/m	930	890	1000	250 Bar

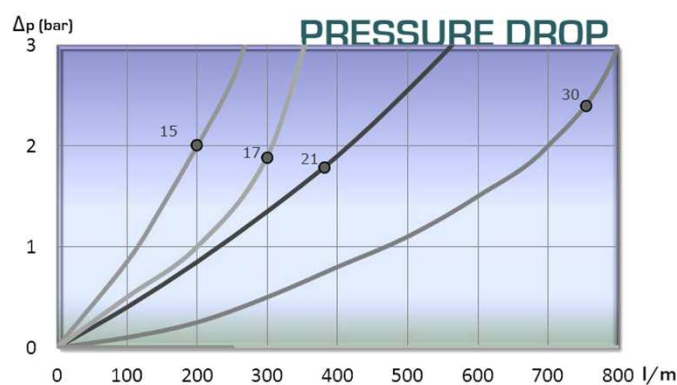
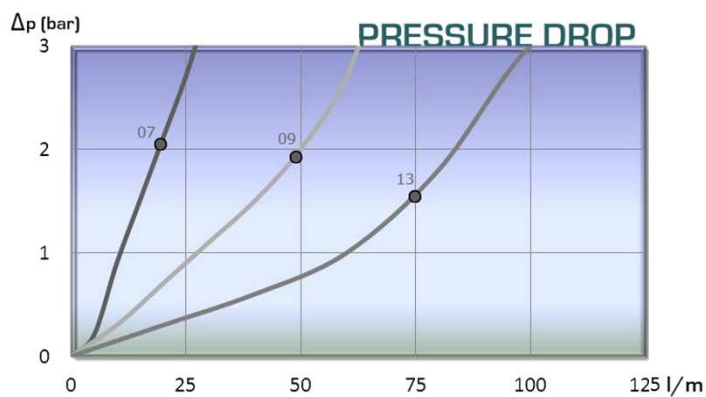





# 131 SERIES CPR

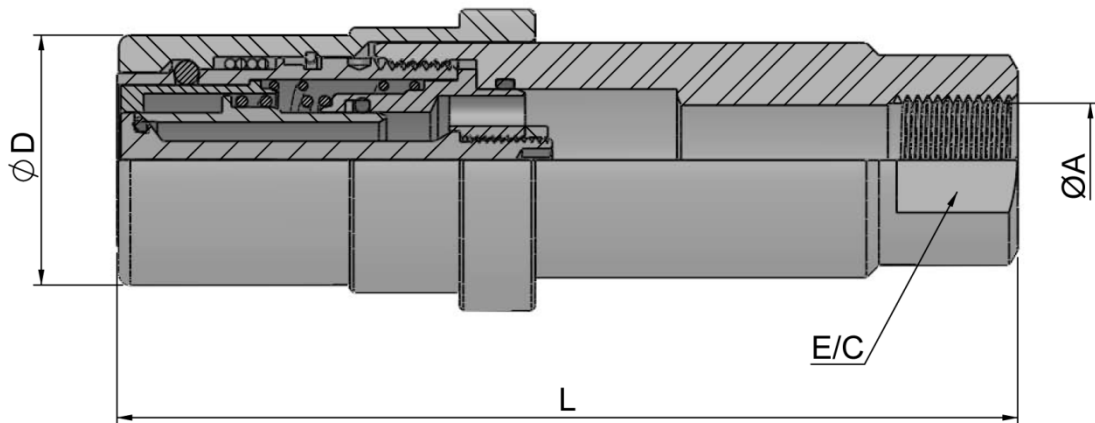
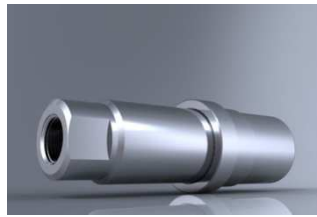

STANDARD MODEL CARBON STEEL						
DN	ØA	REF.		E/C	ØD	L
09	3/8" BSP	131B.12112AC	350	24	33	119

TECHNICAL DATA					
DN	Nominal Flow	Min. Burst Pressure			Max. Working Pressure
		Male	Female	Coupled	
09	45 l/m	1300	1200	1400	350 bar

### Designation

DN-09 FLAT FACE FEMALE 3/8" high pressure to lift trash containers

### Features:

- ✓ Developed for use in working with high frequency pulsating pressure and water hammer.
- ✓ Pressure: 350 bar.
- ✓ Connectable with a residual mean pressure.
- ✓ Nickel plated outer body chemical, very corrosion resistant to ensure durability under the most extreme
- ✓ Ergonomically shaped for easy connection and disconnection.
- ✓ Compact flat face that eliminates leaks and contamination of the circuit.
- ✓ Manufactured under ISO 16028.

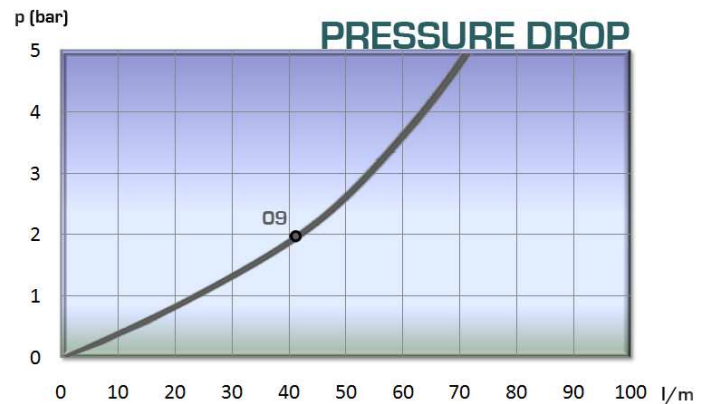



# 131 SERIES

## CPR CAPS



CPR SERIES CAPS have been designed to protect FEMALE (coupler) or MALE (nipple) parts while they are disconnected.  
 Manufactured according to ISO 16028 norm.

### MODEL STRUCTURE

For caps

Example;

## 131.5313 AA

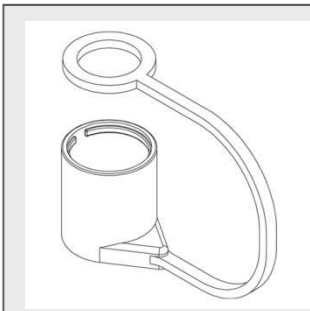
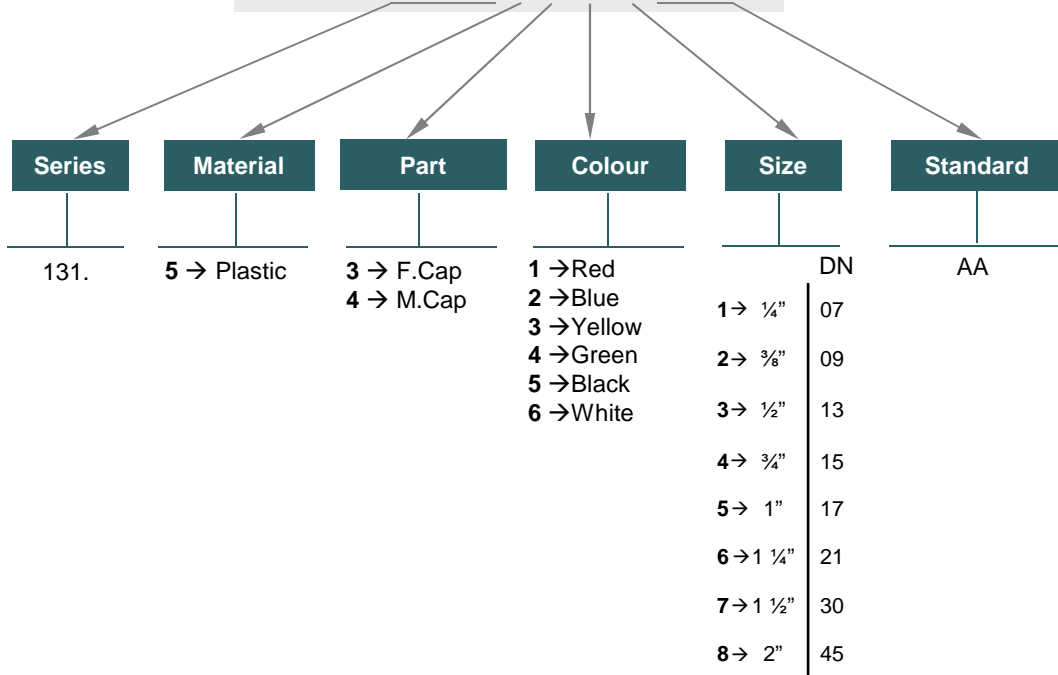

FEMALE CAP						
DN	RED	BLUE	YELLOW	GREEN	BLACK	WHITE
07	131.5311AA	*	*	*	*	*
09	131.5312AA	*	*	*	*	*
13	131.5313AA	*	*	*	*	*
15	131.5314AA	*	*	*	*	*
17	131.5315AA	*	*	*	*	*

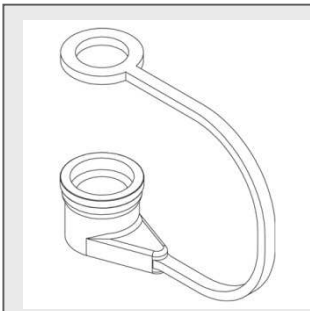

MALE CAP						
DN	RED	BLUE	YELLOW	GREEN	BLACK	WHITE
07	131.5411AA	*	*	*	*	*
09	131.5412AA	*	*	*	*	*
13	131.5413AA	*	*	*	*	*
15	131.5414AA	*	*	*	*	*
17	131.5415AA	*	*	*	*	*

\* Available upon request

\* Use 131 instead of 130 in reference to ask for CPR Caps

## 131-10

